

ZAZA2 PBJ 2

Brevet déposé/Patent deposit

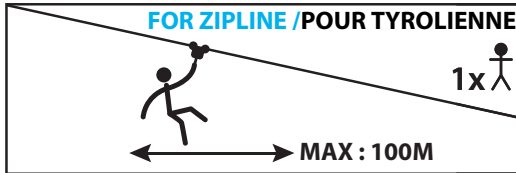
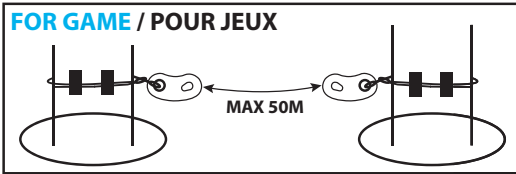

ADVANTAGES / AVANTAGES

- Facile et simple à installer
Easy to install
- 1 Sans SERRE-CÂBLE!
No CLAMP
- 1 Sans maintenance
No maintenance



Safety Line / Ligne de vie :
ø 12 mm or 1/2 "

Galvanized steel wire rope with metal core /
Câble acier galvanisé avec âme métallique :-
-7x19
-Non rotating wire rope / Anti-giratoire
-6x26 Swaged/ Compacté

**⚠ For any other type : do tests
Pour tout autre type : faire des tests**

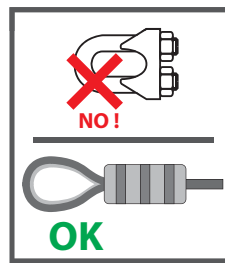

EN 15567-1
EN13411-3

**STANDARDS
ACCT**

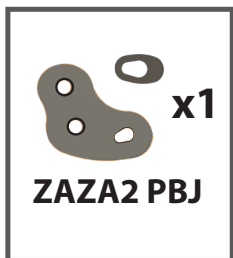

GAME / JEUX
= 1 x 1250 Kg
+ 1 x CT/WLL:1000 Kg

OU

ZIPLINE / TYROLIENNE
= 1 x 2000 Kg
+ 1 x CT/WLL:1000 Kg

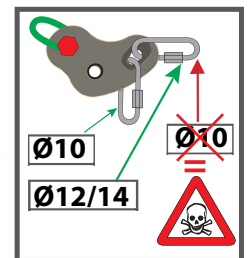

EXEMPLES DE FIXATIONS (liste non-exhaustive) / FIXATION EXAMPLE (non-exhaustive list)

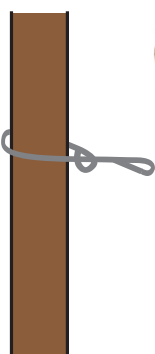

ELINGUE DE LEVAGE RONDE TEXTILE TYPE "E" CMU mini 3 tonnes
ROUND TEXTILE SLING FOR LIFTING TYPE "E" WLL mini 3 tons

NORMES : EN 13411-1/7
STANDARDS:

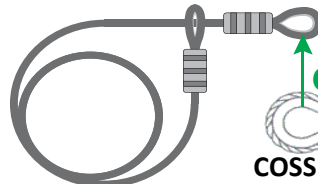
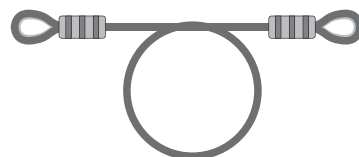

CÂBLES ø12 or 1/2"
ÂME METALLIQUE
METALLIC CORE

COSSE-COEUR / THIMBLE

Chain HR/HS Ø 8/10 Grade 80 mini



La CMU des fixations doit être correctement dimensionnée / WLL of the fixing element must be correctly sized



Une platine de tyrolienne doit impérativement être montée avec une platine backup
A zipline plate must be fitted with a backup plate.

Operation 1

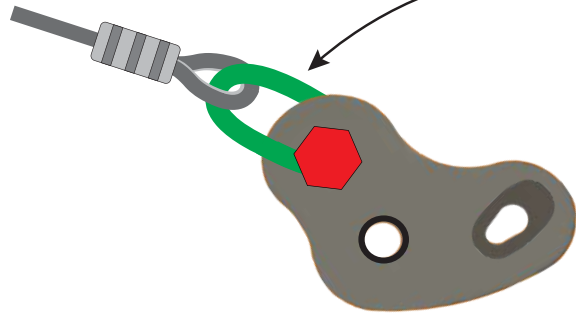

x1

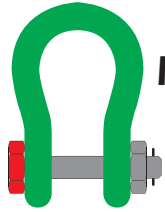

MANILLE LYRE / BOW SHACKLE

= HR 2T - HS 1/2"

STANDARDS OF ASSEMBLY
NORMES DE MONTAGE



EN 15567-1
EN 13411-3
STANDARDS - ACCT

Operation 2

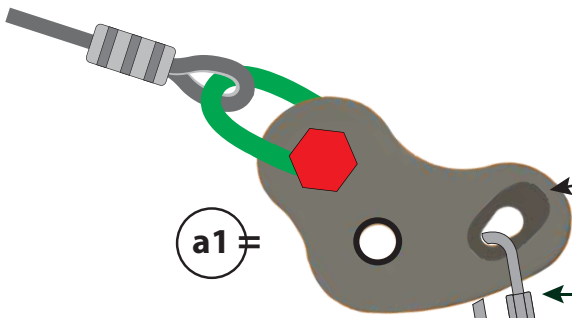

a1 ≠



GUIDING PLATE
PLAQUE DE GUIDAGE

x1 = GO 10 - LO 7/16"

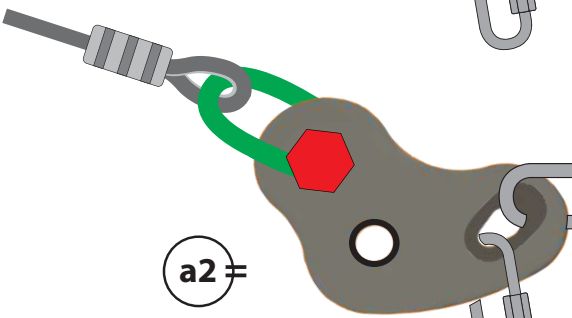

a2 ≠

FOR GAMES / POUR JEUX

x1 = GO 12 - LO 1/2"

FOR ZIPLINE / POUR TYROLIENNE

x1 = GO 14 - LO 9/16"

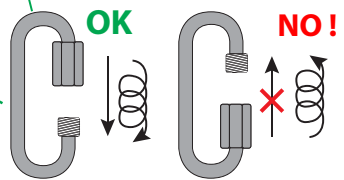

Operation 3

● INSTALLATION of STARTING PLATE
INSTALLATION DE LA PLATINE DE DEPART

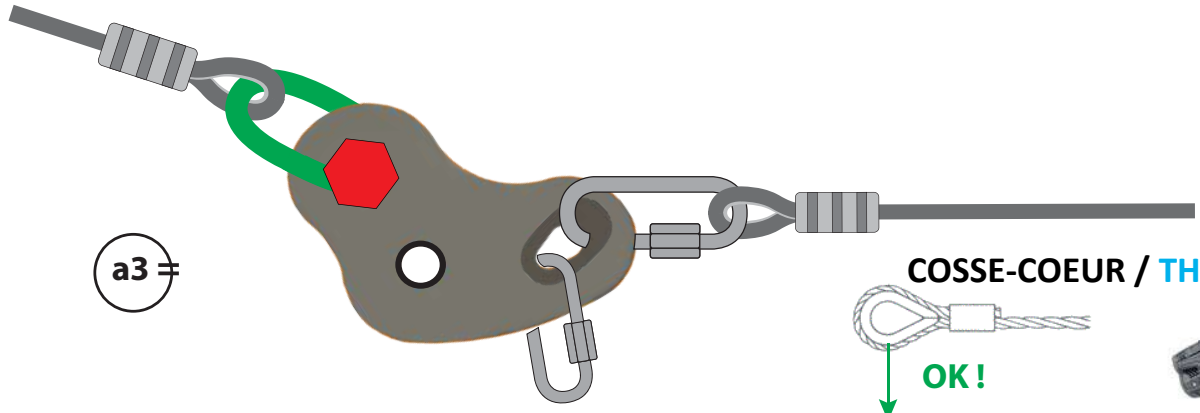

a3 ≠

COSSE-COEUR / THIMBLE



OK!



4x 130KN



Operation 4

- **INSTALLATION of ARRIVALL PLATE**
INSTALLATION DE LA PLATINE D'ARRIVEE

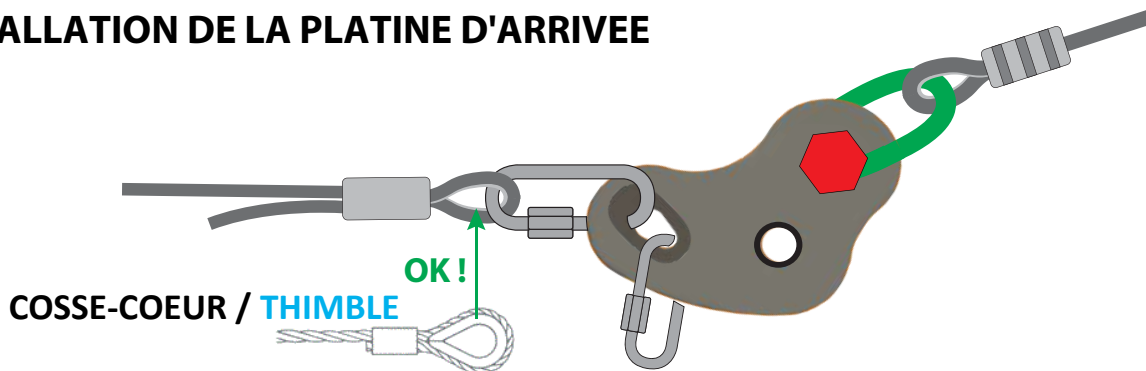

Operation 5

- **CABLE TENSION**
TENSION DU CÂBLE

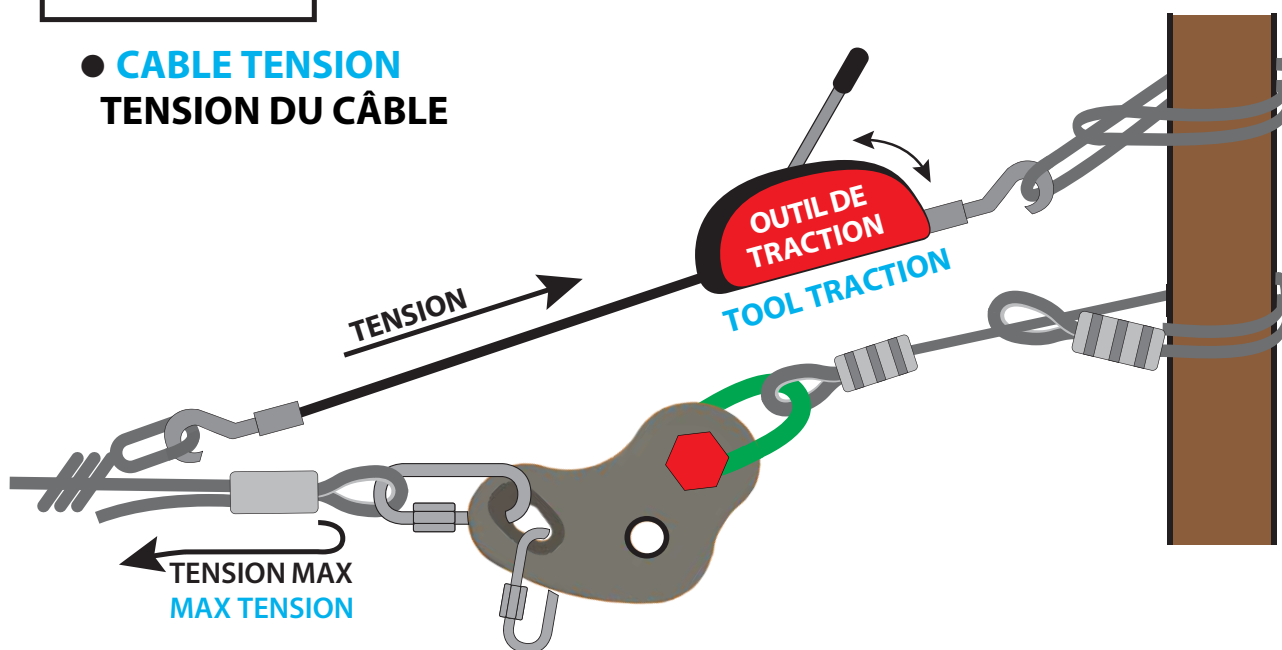

Operation 6

- **TO CRIMP / POUR SERTIR**

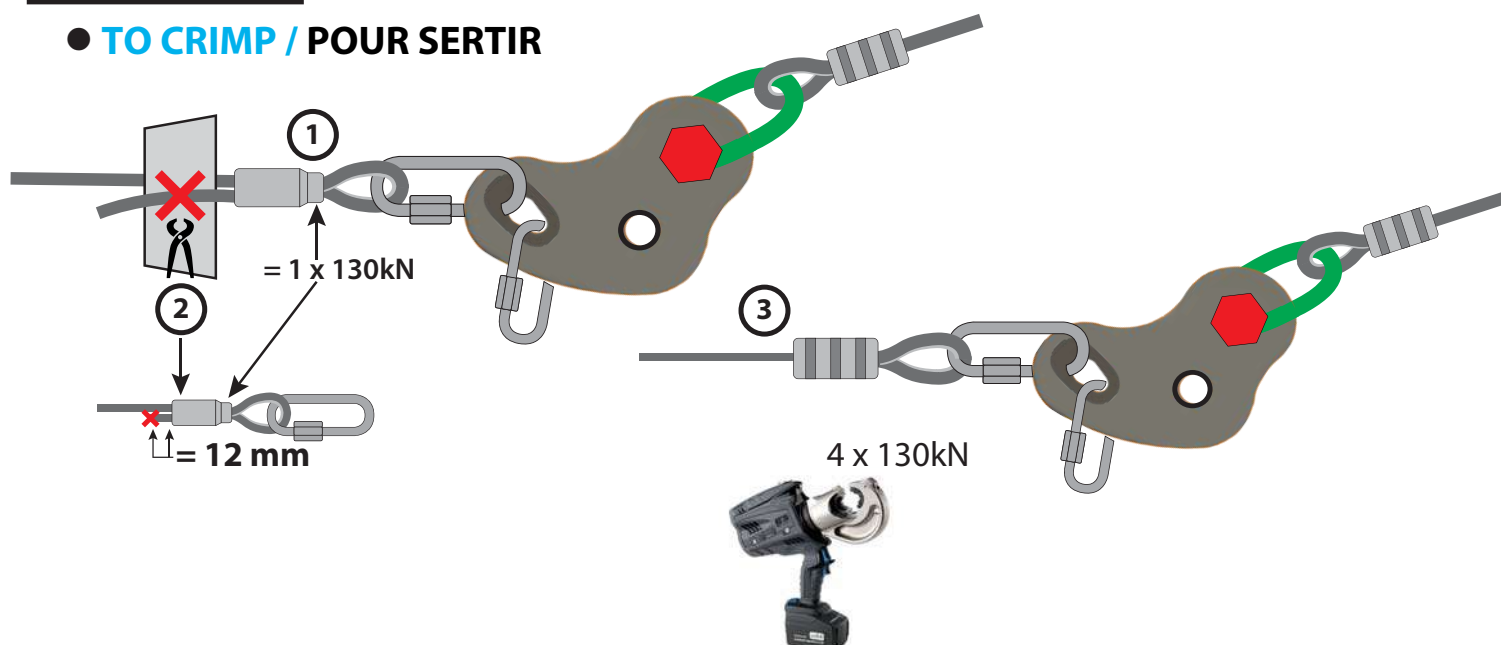

Operation 7

● TENSION SYSTEM FOR ZIPLINE / SYSTEME DE TENSION POUR TYROLIENNE

1

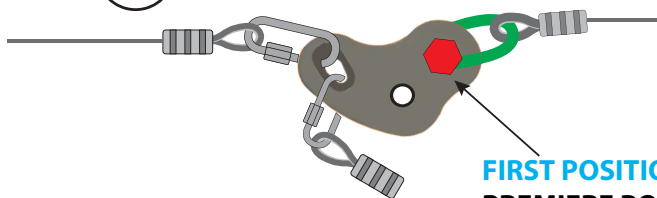

FIRST POSITION
PREMIERE POSITION

2

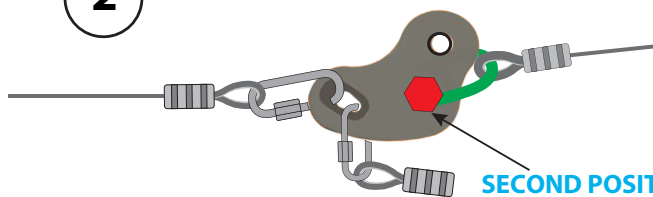

SECOND POSITION
DEUXIEME POSITION

Operation 8

● RECOMMANDATION ASSEMBLY / RECOMMANDATION DE MONTAGE

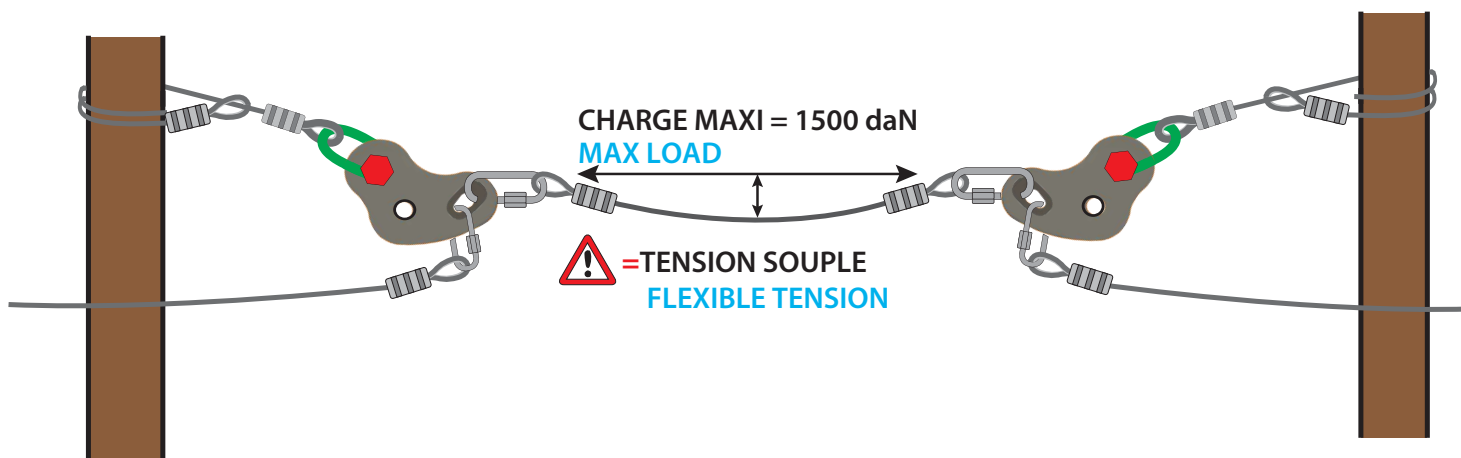

CHARGE MAXI = 1500 daN
MAX LOAD

⚠ = TENSION SOUPLE
FLEXIBLE TENSION

Operation 9

● JUNCTION / JONCTION

NOT contractual Examples
system for fixation
Exemples (non contractuel)
de systèmes de fixations

